

CUSTOMER PART No.

CUSTOMER

CAN ART STD.

DIE No.

EH05315

DESCRIPTION

2" SCHEDULE 80 PIPE

PROPOSAL No.

NOTE: BREAK ALL CORNERS WITH 0.015" (.38 MM) RADIUS UNLESS OTHERWISE NOTED. STANDARD TOLERANCES TO APPLY UNLESS OTHERWISE SPECIFIED.

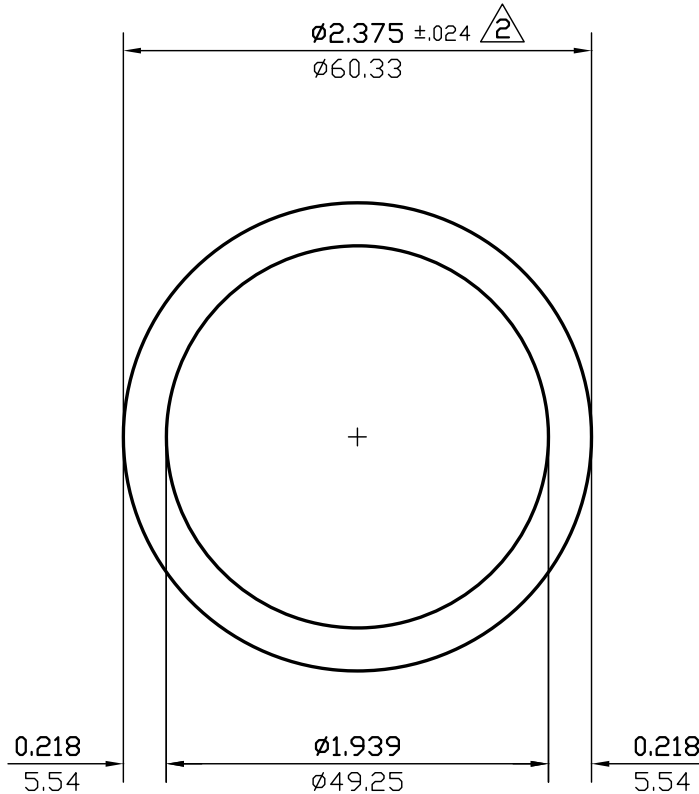

WALL THICKNESS **0.218 (5.54)** EXCEPT AS SHOWN

DATE	REV	DESCRIPTION	BY
03/10/23	3	REMOVED EXPOSED SURFACES AND ALLOY	JASON
07/13/15	2	ADDED $\pm .024$ TOLERANCE. REMOVED HOUSING/INSERT NOTE.	P.M.
EST.AREA	1.477	IN. ²	EST.AREA
			953
			MM. ²
EST.WT.	1.743	LBS/FT.	EST.WT.
			2.594
			KG/M.
EST.PER.	13.553	IN.	EST.PER.
			344.2
			MM.
OUT PER.	7.461	IN.	OUT PER.
			189.5
			MM.
C.C.D.	2.375	IN.	C.C.D.
			60
			MM.
FACTOR	8	FINISH	M/F
		ALLOY & TEMP.	
CKD BY	SCALE	1:1	DWN BY
			J.D.
			DATE
			02/28/92

CAN ART

ALUMINUM EXTRUSION INC.

85 PARKSHORE DRIVE
BRAMPTON, ONT L6T 5M1
TEL. NO. (905) 791-1464
FAX NO. (905) 791-9151
E-MAIL: canart@canart.com

THIS DRAWING IS NOT NECESSARILY A COPY OF YOUR ORIGINAL. PLEASE APPROVE DIMENSIONS AND TOLERANCES INDICATED. CAN ART ASSUMES NO RESPONSIBILITY EITHER TECHNICAL OR LEGAL FOR HAVING THIS SHAPE MADE. THE CUSTOMER AGREES TO FULLY PROTECT CAN ART ALUMINUM FROM CLAIMS OF OTHERS RESULTING FROM THIS SHAPE.

SIGNED: _____ DATE: _____